

FIGAT7TH

INTERSECTION OF LIFE × STYLE



BANK OF AMERICA
PLAZA

WELLS FARGO CENTER
NORTH TOWER

WELLS FARGO CENTER
SOUTH TOWER

HALO

FIGUEROA AT
WILSHIRE

7TH ST. / METRO
CENTER STATION

110 FREEWAY

FIGAT7TH

WHY DTLA?

OVERVIEW

5.84 SQ. MILES

Radius of DTLA

\$35 BILLION

Invested in DTLA Since 1999

9 MILLION

Visits a Month to DTLA

\$4.8 BILLION

Retail Sales in 2022

MOST ACCESSIBLE

Region in Greater Los Angeles Linked
by Public Transit/Metro System

STRONG MARKET DEMOGRAPHICS

80,000

Residents

\$123,000

Residents Avg. HH Income

62%

Residents Aged 25-49

500,000

Average Daily Population

\$122,000

Workers Avg. HH Income

59%

Workers Aged 30-54

BOOMING RESIDENTIAL MARKET

43,425

Units Constructed
Since 1999

4,655

Units Under Construction

93%

Occupied in Current Stock

29,170

Units Proposed

37%

Residential Population
Growth from 2010 to 2022



"Every structure seems to house artists, musicians, designers, tech developers, chefs—the whole Who are the people in your neighborhood of the creative class. After decades of being all but forgotten, Downtown has approached a critical mass of cool..."

GQ MAGAZINE



IN GOOD COMPANY

DTLA HAS SO MUCH TO OFFER

1



Danny Boy's Pizza
KinderCare
Nick + Stef's Steakhouse
Trejo's Tacos
(more coming soon)

2

THE BLOC

Alamo Drafthouse Cinema
Bellalina Gelato
Bring Something to the Party
Café Balzac
District Bar/Kitchen
DRNK Coffee + Tea
Drybar
DTLA Proud A+R=T
Community Center
Eyes on The Bloc
Farmer's Fridge
GNC Live Well
Hatch Yakitori + Bar
Jewelry Pavilion
Joey Restaurants
Korean Kimbap Express
LA Fitness
Lamay Nail Spa
LAN Auto Detailing
Macy's Flagship
Marco Valentino
Marugame Udon
Oil + Cream Spa
Paper Source
Sculpt
Starbucks
T-Mobile
UCLA Health
Uniqlo
USPS
Video Vortex
Your Cleaners Online

3

L.A. LIVE

The Agave Library at Sendero
Coke Studio at LA Live
Craft by Smoke & Fire
Corteza at Sendero
Crypto.com Arena
Fixins Soul Kitchen
Fleming's Prime Steakhouse
Glance Lobby Bar
Grammy Museum
Illy Caffè
Katsuya
Lazy Dog Restaurant & Bar
Leña at Sendero
LA Convention Center
Lucky Strike Lanes
The Mixing Room
The Novo
Peacock Theater
Peacock Place
Regal Cinemas L.A. LIVE
Ritz-Carlton Spa
Savoca
Smashburger
Sol Agave
Starbucks
TEAM LA Store
Tom's Watch Bar
Yard House

4

BROADWAY
RETAIL
CORRIDOR

Acne Studios
Adidas
Aesop
Apple Store
Foot Locker
Gentle Monster
Jordan Brand / Jumpman
Mykita
PacSun
Paul Smith
Ross Dress for Less
Urban Outfitters
Vans
West Elm

5

GRAND
CENTRAL
MARKET

Ana Maria
Bastion Bakery
Bento Ya Japanese Cuisine
Berlin Currywurst
Broad Street Oyster Co.
China Café
Donut Man
Eggslut
Fat & Flour
For The Win
Ghost Sando
Go Get Em Tiger
Golden Road
Grand Central Jewelry
Jose Chiquito
The Juice
Knead & Co. Pasta
La Fruteria
La Huerta Candy
La Tostaderia
Lucky Bird
Maple Block
McConnell's Fine Ice Cream
Moon Rabbit
Nonna's Empanadas
Olio Wood Fired Pizzeria
Photomatica
The Oyster Gourmet
Ramen Hood
Roast To Go
Sarita's Pupuseria
Shiku
Sticky Rice
Sushi Rush
Tacos Tumbras a Tomas
Teddy's Tiny Bites
Torres Produce
Valeria's
Villa Moreliana
Villa's Tacos
Wexler's Deli



NOTABLE
HOTELS

The AC Hotel
citizenM Hotel
Conrad Los Angeles
Courtyard Los Angeles L.A. Live
The Delphi Hotel
Downtown LA Proper Hotel
Freehand Los Angeles
Hilton Checkers Hotel
Hotel Figueroa
Hotel Indigo
Hotel Per La
Hoxton Hotel
InterContinental Hotel
JW Marriott
Mayfair Hotel
Millennium Biltmore Hotel
The Moxy
O Hotel
The Ritz-Carlton Los Angeles
Sheraton Grand
The Wayfarer
Westin Bonaventure

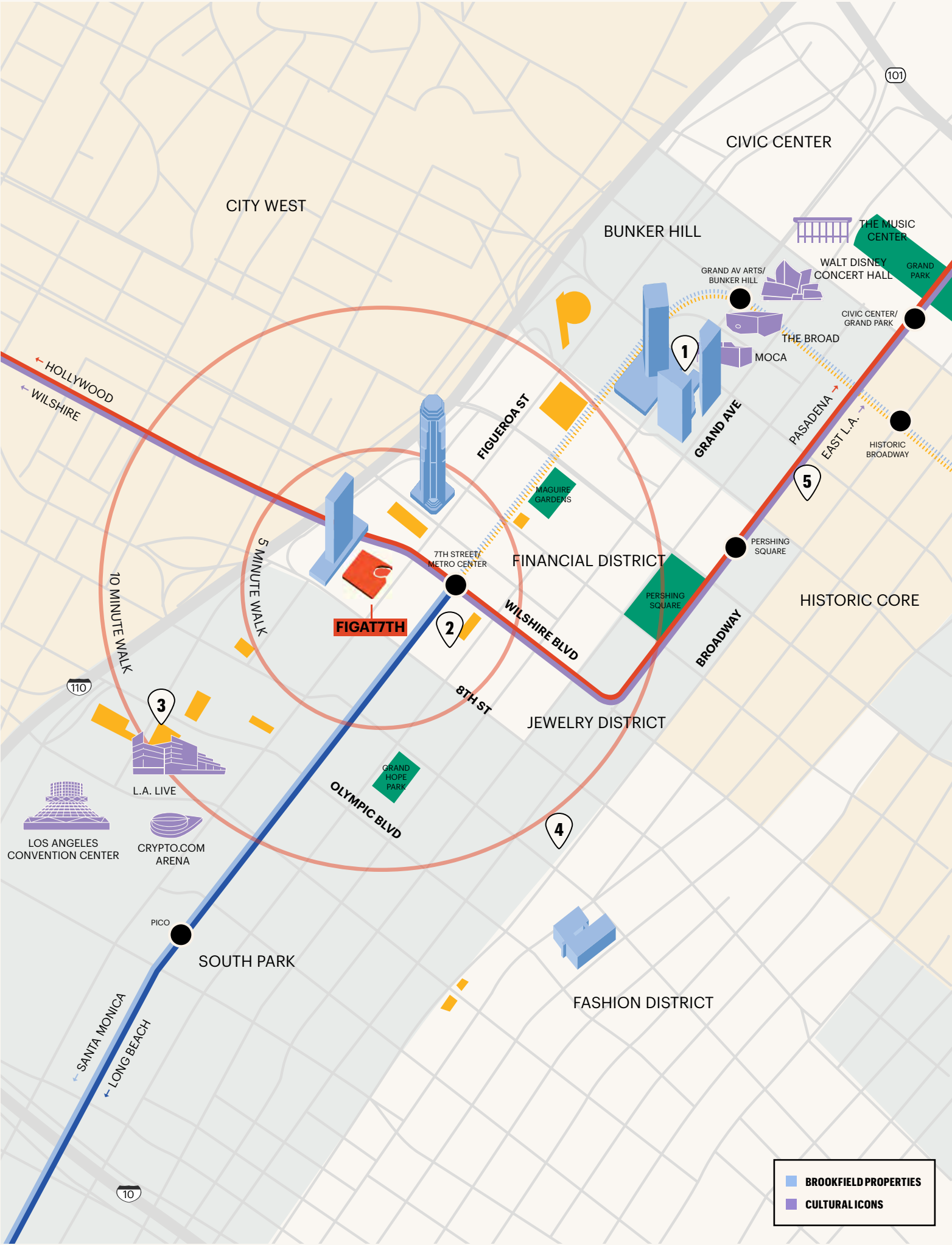

LOS ANGELES

FIGAT7TH TO...

LOS ANGELES
INTERNATIONAL AIRPORT

15 Miles

BOB HOPE BURBANK AIRPORT

16 Miles

HOLLYWOOD

8 Miles

BEVERLY HILLS

10 Miles

SANTA MONICA

15 Miles





IN THE HEART OF DTLA

OPEN-AIR SHOPPING & DINING

In the heart of Downtown Los Angeles, FIGat7th stands as a shopping, dining, and fitness destination with a decidedly Southern California flavor. Enhanced by Brookfield's \$40 million makeover, this open-air lifestyle center offers a modern, urban retail experience for DTLA's professional and residential population, as well as visitors to the cultural hub of Los Angeles. This premier shopping venue for Downtown Los Angeles showcases fan favorites Zara, H&M, Nordstrom Rack, Target, Sephora, and Victoria's Secret.

FIGat7th boasts more than 300,000+ SF of retail and public space, including TASTE Food Hall, a thriving, global collection of fast-casual eateries. FIGat7th also offers indoor and outdoor seating for more than 500 guests, including an outdoor courtyard and park-like Plaza level with café-style dining.



FIGAT7TH RETAILERS

SHOPPING

Bath & Body Works x H&M x Mango
Nordstrom Rack x Sephora x Sunglass Hut x Target
Victoria's Secret x Victoria's Secret PINK x ZARA

DINING

California Pizza Kitchen x CoCo Fresh Tea & Juice
Five Guys x George's Greek Grill x Indus by Saffron
Mendocino Farms x Mighty Bowl x New Moon Café
Ocho Mexican Grill x Oleego by Parks BBQ
Ranch & Maple Salata x Sbarro x Sprinkles Cupcakes
Starbucks x The Melt x Velo Coffee

FITNESS + SERVICES

DownTown Hi-Tech x Gold's Gym x LensCrafters x T-Mobile



FIGAT7TH RATED MOST POPULAR SHOPPING DESTINATION

by both residents and workers in the 2020 Downtown LA survey performed by the DCBID

SHOPPER PROFILE

1,241,003

Trade area
(resident population)

42,612

Daytime population
within four blocks

49%

Shoppers between the ages
of 25-44

AVERAGE TIME SHOPPERS VISIT

7.4X /MO

(vs. a U.S. benchmark of
2.6x per month)

AVERAGE SPENT PER SHOPPER

\$384.13/MO

(vs. \$255.89 U.S. benchmark)

EDUCATION

63%

residents with post-secondary
education

CONVENIENT LOCATION

**BUSIEST PEDESTRIAN
INTERSECTION IN DTLA**

at the 7th and Figueroa intersection

**BUSIEST METRO RAIL
STATION IN LA**

at the 7th Metro Center, adjacent to FIGat7th

DEDICATED ONSITE PARKING

with complimentary charging stations

HOW DO SHOPPERS GET HERE?

37% WALK

34% DRIVE

24% PUBLIC TRANSPORTATION

FIGAT7TH BLOCK

2 MILLION SQ. FT.

onsite office towers

780+ UNIT

Brookfield Properties residential tower



LOWER LEVEL – M1

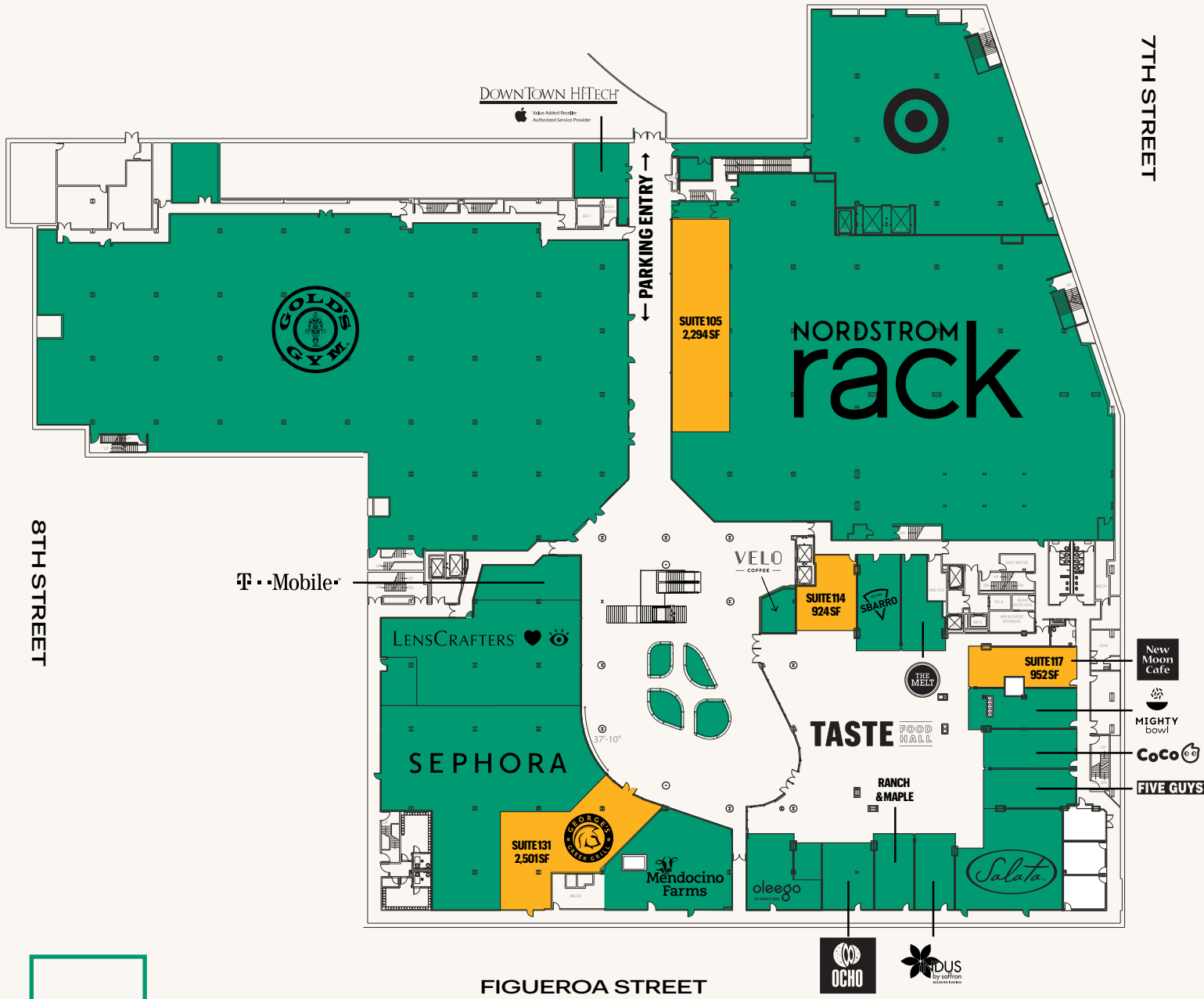

MIDDLE LEVEL – M2

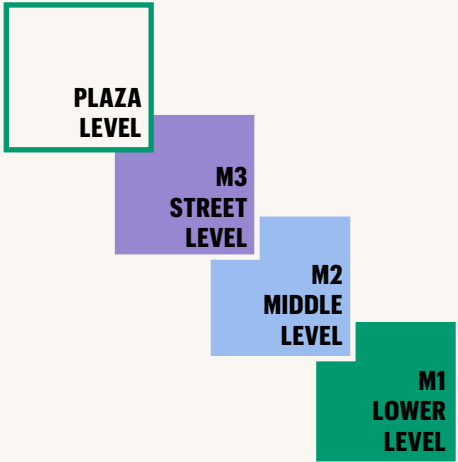

AVAILABLE OPPORTUNITIES

AVAILABLE OPPORTUNITIES

STREET LEVEL – M3

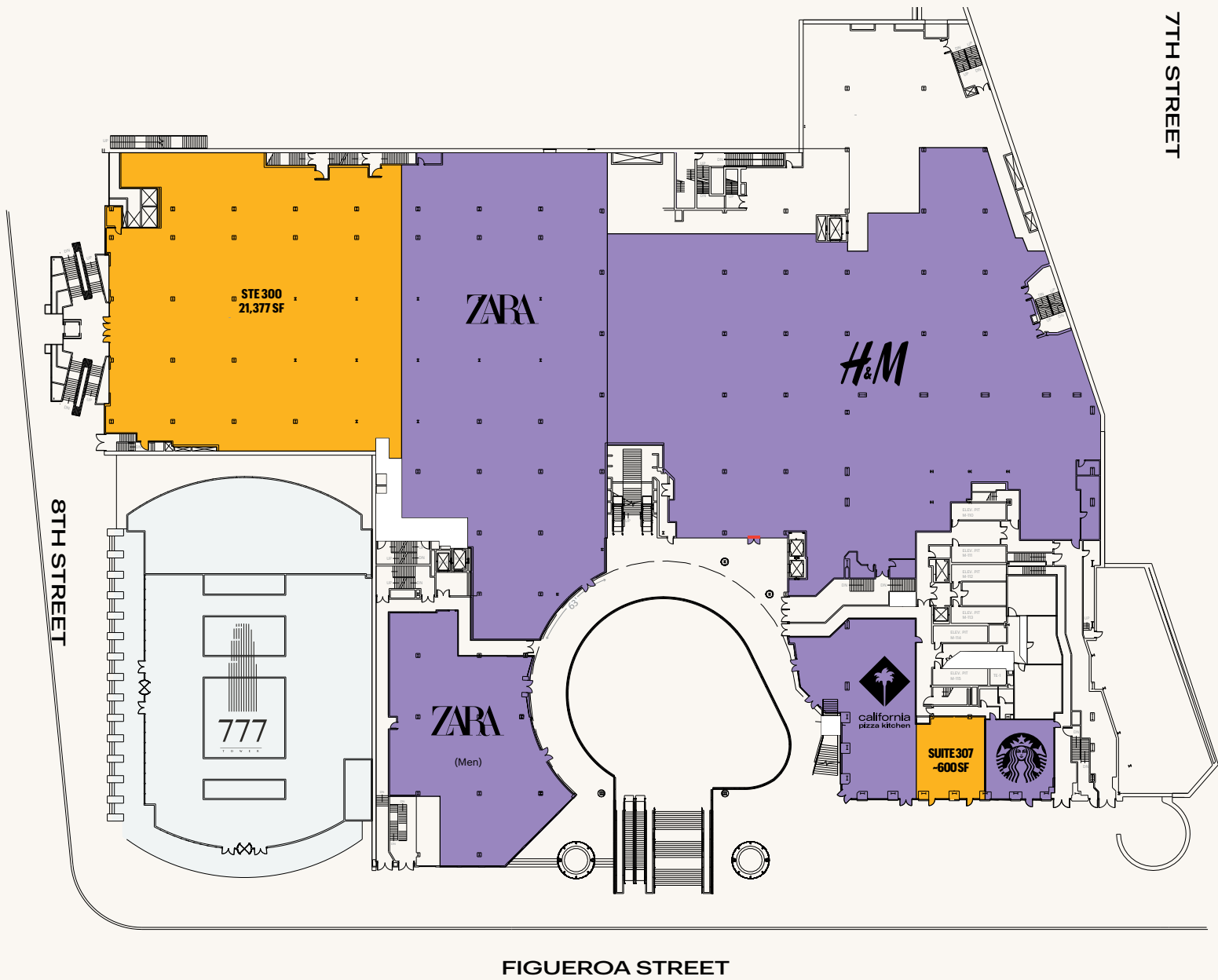

PLAZA LEVEL

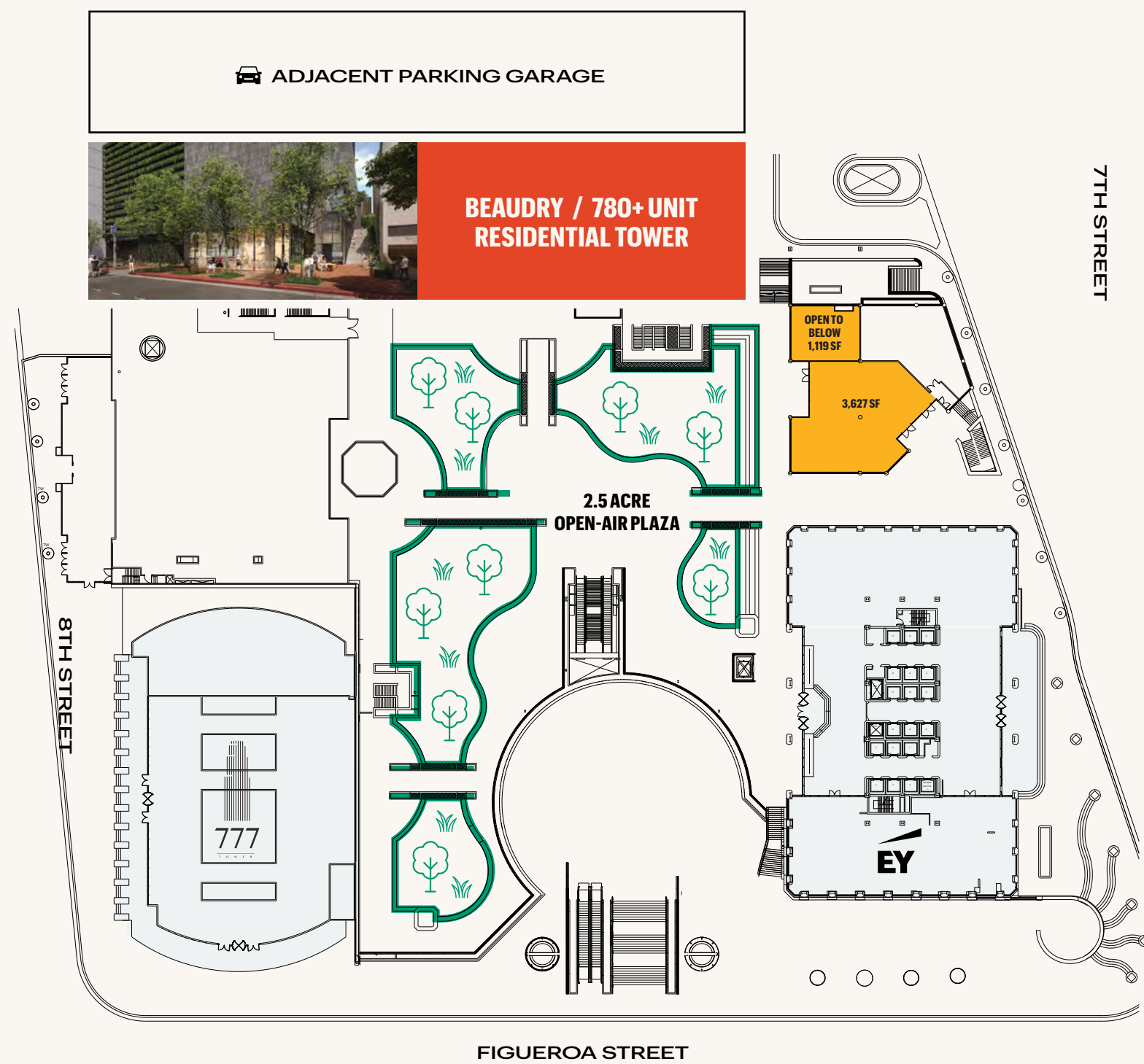



THE BEAUDRY

Adjacent to FIGat7th, is a high-rise development project, the Beaudry, featuring 750+ rental residences with best-in class finishes, amenities, and unparalleled views of the City.

It is the final piece of a superblock, encompassing a true live/work/shop mixed-use community, which is unprecedented in downtown Los Angeles. The residential shares the Plaza Level with FIGat7th.

BROOKFIELD PROPERTIES

WE ARE IN THE BUSINESS OF CREATING PLACES

We aim to make lasting impressions on the cities and neighborhoods in which we do business. The architecture of our iconic projects define skylines and streetscapes around the globe, and the commercial districts we create combine both historic and modern architecture. Our distinctive place making integrates destination shopping, dining and amenities on-site; the highest standards in sustainability and efficiency; and a strong social, cultural and community involvement. Brookfield is setting a new benchmark for the modern urban live-work-play environment, embracing the changing lifestyle of today's sophisticated individual.

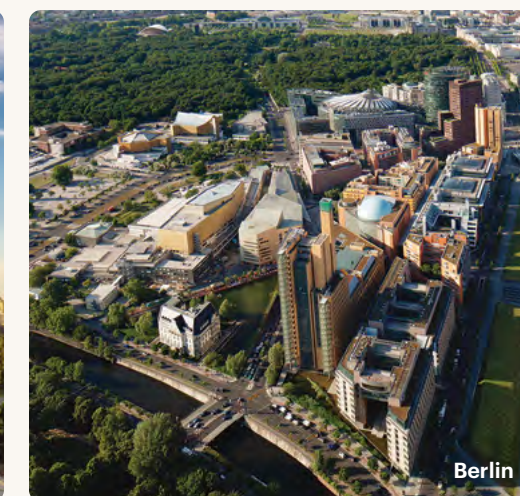
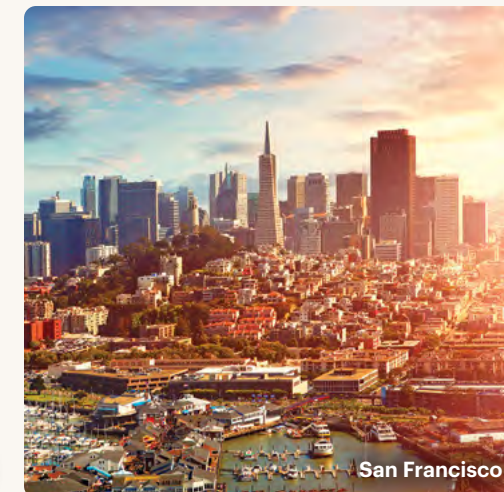
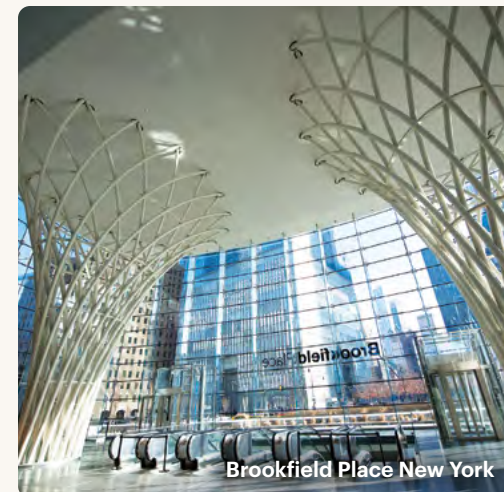
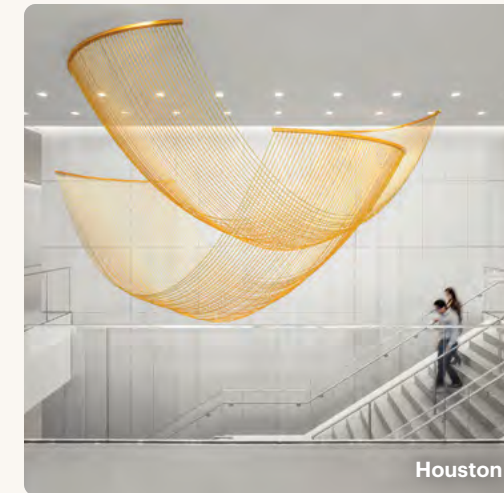
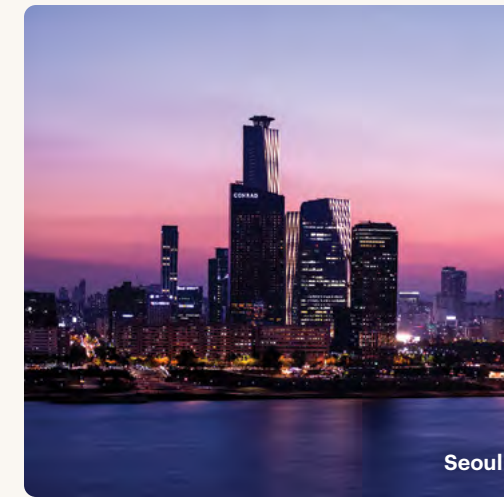



LEASING CONTACT:

RACHAEL ZANETOS

rachael.zanetos@brookfieldproperties.com

(818) 459-6840

LICENSE ID: 01718390